

TYPE: JFA01
(Single Bolt)

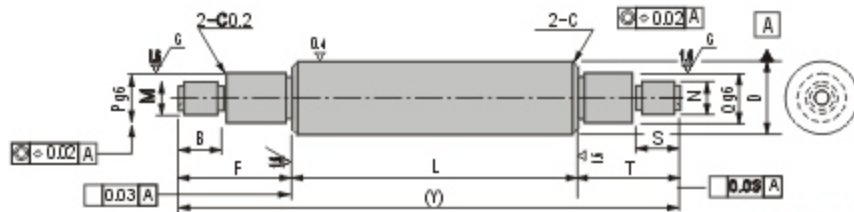

TYPE: JFA02
(Double Bolt)

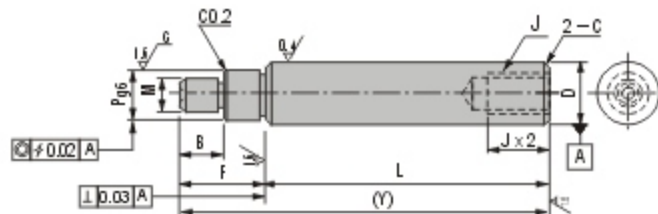

TYPE: JFA03
(Inner Bolt + Black Oxidized)

Type: JFA01~JFA03

Material: SUJ2 - 1.3505 - High Carbon Chrome Bearing Steel
Hardness: HRC 58+4 Through High Frequency quenching

Dg6	1 mm Increments				M · N (Rough Thread) (SELECT)	J (Rough Thread) (SELECT)	(Y) MAX.	C
	L	F · T	B · S	P · Q				
4		25~195			3	2	200	Be low 0.2
5	-0.004	25~295			3 4	2.6 3	300	
6	-0.012	25~295			3 4 5	3	300	
8	-0.005	25~295			3 4 5 6	3 4 5	300	Be low 0.5
10	-0.014	25~345			4 5 6 8	3 4 5 6	350	
12		25~345	$5 \leq F \leq P \times 5$	B=0 S=0	5 6 8 10	4 5 6 8	350	
13		25~345		M ≤ P ≤ D	5 6 8 10	4 5 6 8	350	
15	-0.006	25~345	$5 \leq T \leq N \times 5$	M × 1 · B ≤ M × 3 N × 1 · S ≤ N × 3	5 6 8 10 12	4 5 6 8 10	350	
16	-0.017	25~345			5 6 8 10 12	4 5 6 8 10	350	Be low 1.0
18		25~345			5 6 8 10 12	4 5 6 8 10 12	350	
20		25~445			6 8 10 12 16	4 5 6 8 10 12	450	
25	-0.007	25~445			6 8 10 12 16 20	4 5 6 8 10 12 16	450	
30	-0.020	25~445			8 10 12 16 20 24	6 8 10 12 16 20	450	

Order Example: - - - - - - -
 - - - - - - -

■ Customize are also available

Precision Shaft With Undercut

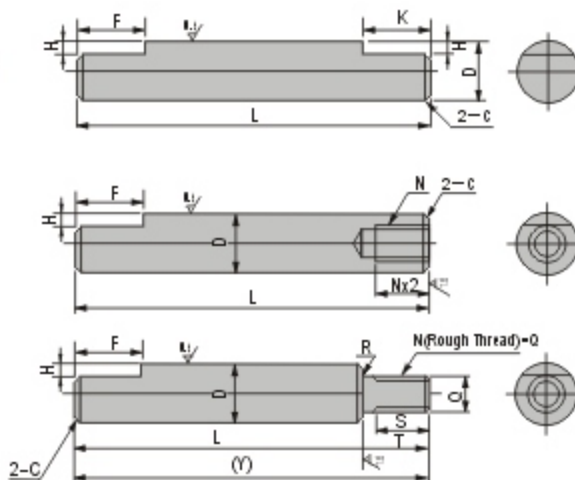

TYPE : JFA04
(Double Undercut)

TYPE : JFA05
(Single Undercut)

TYPE : JFA06
(Single Undercut+Thread)

Type: JFA04~JFA 06

Material: SUJ2 - 1.3505 - High Carbon Chrome Bearing Steel
Hardness: HRC58+4 Through High Frequency quenching

"D" Tolerance			
Dg6		Dt8	
4	-0.004	-	-
5	-0.012	-	-
6		6	-0.010 -0.028
8	-0.005	8	-0.013
10	-0.014	10	-0.035
12		12	
13		13	
15	-0.006	15	-0.016
16	-0.017	16	-0.043
18		18	
20		20	
25	-0.007	25	-0.020
30	-0.020	30	-0.053
35		35	
40	-0.009	40	-0.025
	-0.025	40	-0.064
50		50	

D	1mm Increments				N (Rough Thread) (SELECT)	Q (SELECT)	(Y) MAX	H	R	C
	L	F	K	T						
4	25~300	2<F<K<3:0	2<T<Q<5	ST=T/2	2	3 4	300	0.5	Below 0.2	Below 0.2
5	25~400				2.6 3	3 4 5	400			
6	25~600				3	3 4 5 6	600			
8	25~800				3 4 5	3 4 5 6 8	800			
10	25~800				3 4 5 6	4 5 6 8 10	800			
12	25~1000				4 5 6 8	5 6 8 10 12	1000			
13	25~1000				4 5 6 8	5 6 8 10 12	1000			
15	25~1000				4 5 6 8 10	5 6 8 10 12	1000			
16	30~1200				4 5 6 8 10	5 6 8 10 12 16	1200			
18	30~1200				4 5 6 8 10 12	5 6 8 10 12 16	1200			
20	30~1200	(When thread)	6 8 10 12 16 20	1200						
25	35~1200	S=0	8 10 12 16 20 24	1500						
30	35~1500	(When thread)	8 10 12 16 20 24 30	1500						
35	35~1500		10 12 16 20 24 30	1500						
40	50~1500		12 16 20 24 30	1500						
50	65~1500		12 16 20 24 30	1500						

Order Example: - - - - - - -
 - - - -

■ Customize are also available